

# Optical Mounts

## 830-0010 • 830-0020 SELF-CENTRING LENS MOUNTS



830-0020



830-0010

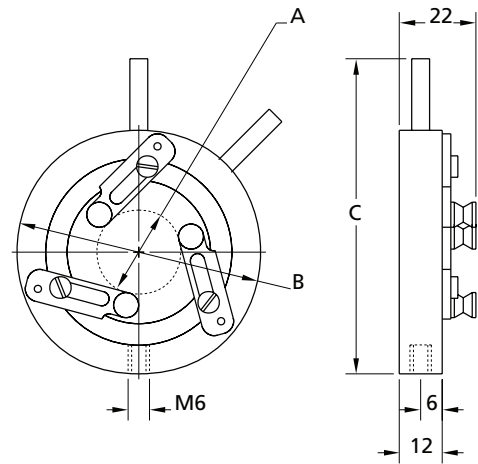

The model 830-0010 and model 830-0020 self-centring lens mounts reliably centre and safely hold round optics and cylindrical components. Holding by three rods with V-groove tips provide easy and secure optics accommodation with high relocation repeatability.

Model 830-0010 and 830-0020 mounts may be attached to series 820-0010 standard rods and then with series 820-0050 rod

holders or series 820-0040 rod translators be located on the table. Alternatively, sets of riser blocks and movable bases provide a selection of convenient, various axes height and direct location to table.

Model 830-0010 accommodates optics up to 40 mm and model 830-0020 up to 60 mm in diameter.

Finish: black anodized aluminium.

Code	Amin, mm	Amax, mm	B, mm	C, mm	Weight, kg
830-0010	8	40	68	88	0.10
830-0020	8	60	88	108	0.13

### Complementary Products

Code	Page
820-0010	5.37
820-0040	5.38
820-0050	5.38

**830-0030**
**ADJUSTABLE LENS MOUNTS**

The 830-0030 series adjustable lens mounts provide convenient, precise optics centering and repeatable removal and replacing. Lenses are positioned and locked in place by three rigid shaft assemblies with V-groove tips. Each individually adjustable shaft incorporates a sliding sleeve for rough positioning and diameter setting and collet fix sleeve in place. A thumbscrews at the end of two orthogonal sleeves then provide fine X-Y position adjustment within 3 mm range.

Mounting holes on the support ring provide easy attachment to all mounting elements.

Finish: black anodized aluminium.

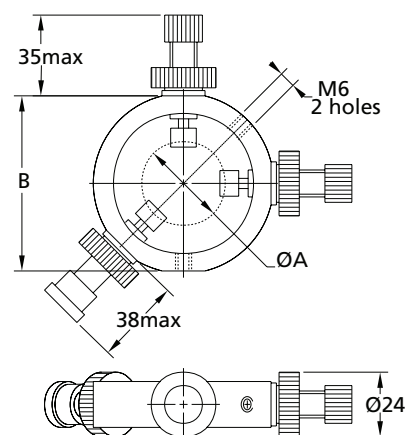

Code	Amin, mm	Amax, mm	B, mm	Weight, kg
830-0030-02	20	45	65	0.21
830-0030-04	40	65	85	0.23
830-0030-06	60	85	105	0.25

**Complementary Products**

Code	Page
820-0010	5.37

**830-0035**
**UNIVERSAL ADJUSTABLE LENS/OPTICS MOUNTS**

- Holding of cylindrical objects of various diameters
- Three mounting possibilities
- Convenient storage of tips which are not used at the moment
- Quick coarse positioning and diameter setting possibility
- Made of black anodized aluminium

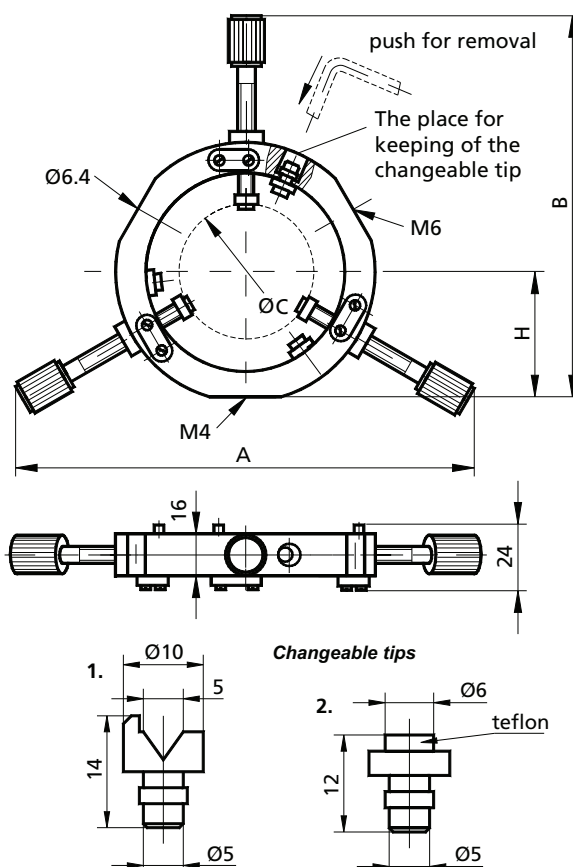

Continued 830-0035

Universal Adjustable Lens/Optics Mounts 830-0035-04 and 830-0035-02 are used to accommodate any round and thickness objects as lenses, mirrors and lasers. Three support shafts of holder are assembled with non-rotating V-groove aluminium universal interchangeable tips for lenses mirrors, etc. While not in use the new non-abrasive flat teflon face aluminium tips for lasers are kept in special holes on aluminium support ring. Long objects like cylindrical laser heads can be held with two chucks.

Each individual adjustable shaft of holder incorporates threaded thumbscrew, sliding sleeve and fixation tool for rough positioning and diameter setting. It is enough to give only a twist thumbscrew of the shaft to provide a fine adjustment travel.

Three various mounting holes M4, M6, and Ø6.4, Ø11x4 provides various and easy attachment possibilities to the Tables, Breadboards and Rod Holder system.

Code	A, mm	B, mm	C, mm	H, mm	Weight, kg
830-0035-04	164-210	158-185	38-103	65.7	0.30
830-0035-02	134-164	124-141	10-66	49.1	0.25



830-0035 and 810-0035

Complementary Products

Code	Page
810-0035	5.27

**830-0037 OPTICAL COMPONENT MOUNTS**

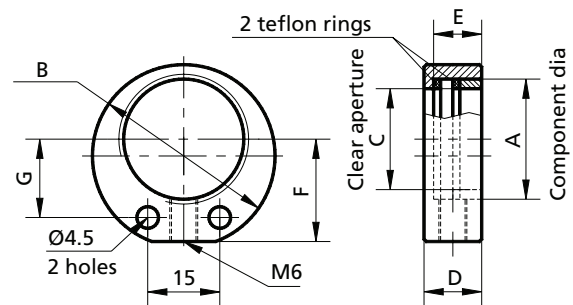

Optical Component Mounts 830-0037 can be used to hold round and thin optical elements of standard sizes. Mounts vary in dimensions so as to support diameters from 10 to 50 mm (0.5" to 2"). Original

design allows to decrease the mount's dimensions and weight.

Mounting holes: one M6 and two Ø4.5mm. Material: black anodized aluminium.

Code	A	B	C	D	E	F	G	Weight, kg
830-0037-10	12.7 (0.5")	26	8	12	10	13.5	8.5	0.01
830-0037-20	20	33	17	12	10	18.8	13.8	0.02
830-0037-25	25.4 (1")	38	23	12	10	21.3	16.3	0.02
830-0037-40	40	53	37	18	16	28.8	23.8	0.04
830-0037-50	50.8 (2")	65	48	18	16	34.8	29.8	0.05
830-0037-75	75	89	72	18	16	46.5	42	0.06

OPTICAL TABLES  
BRACKETS & RAILS  
BASE MOUNTS & ACCESSORIES  
OPTICAL MOUNTS  
OPTICAL POSITIONERS  
BASE POSITIONERS  
TRANSLATION & ROTATION STAGES  
ADJUSTMENT SCREWS  
MOTORIZED POSITIONERS  
OPTO-MECHANICS SETS

**830-0040**
**VARIABLE LENS HOLDER**

The model 830-0040 variable lens holder provides optics from 15 mm to 78 mm in diameter registration. A top spring-loaded clamp holds optics of any configuration gently but firmly within V-shaped mounting base. Kinematic clamp height fixing provide convenience when optics removed and replaced.

Model 830-0040 holder is useful for thin lenses holding.

Finish: black oxidized steel.

Code	Weight, kg
830-0040	0.36

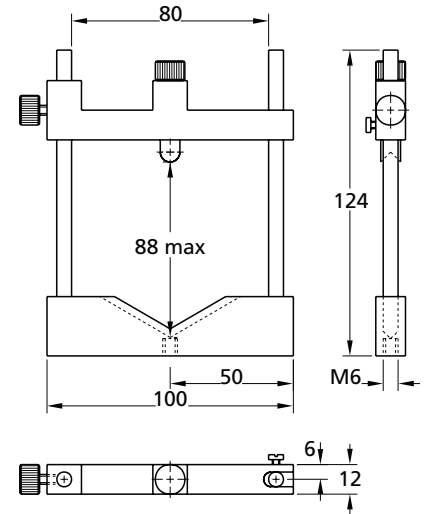
**830-0050**
**OPTICS CLAMP**

The 830-0050 clamp is especially convenient for fast optical elements clamping on bases, translators, rotators and other surfaces with M6 and M4 tapped holes.

Rod material: Stainless steel.

Clamp finish: black anodized aluminium



**830-0055**
**PLATE CLAMP**

Plate Clamp 830-0055 holds thin light-weight plates, like filters, transparencies, resolution targets and razor blades used in knife edge experiments.

These black finished steel Clamps may be directly screwed for example to the mounting stud of a Mounting Post or to a Base Plate with Rotary Clamp 820-0130.

Code	Weight, kg
830-0055	0.04

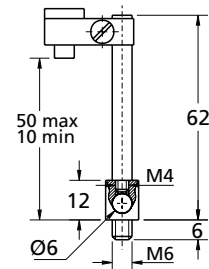
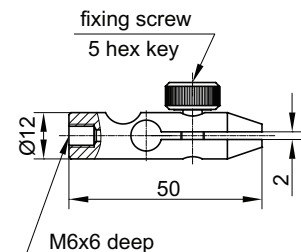

**830-0060 • 830-0070 FILTER HOLDERS**



The model 830-0060 and model 830-0070 filter holders provide safe, separate, with maximum clear aperture plate optics location and offer quick change convenience. Each plate held separately to prevent scratching and is registered by dovetailed pins for easy relocation. Holders are convenient and useful for quick coloured or neutral density filters combination adjustment.

Model 830-0060 holder holds up to two, while model 830-0070 up to five optics plates with dimensions 40×40 mm (max 80×80 mm) or Ø40 mm, thickness up to 4.5 mm in vertical position.

Finish: black oxidized steel.

Code	Weight, kg
830-0060	0.10
830-0070	0.13

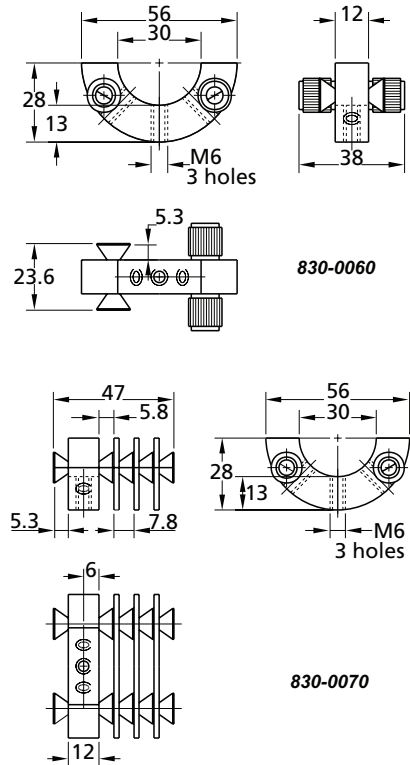

**830-0075 UNIVERSAL PLATE HOLDER**



Universal Plate Holder 830-0075 holds long and thick components, and can fix elements from 0 to 12 mm in width. The base of the plate holder has an M6 mounting hole.

Code	Weight, kg
830-0075	0.07

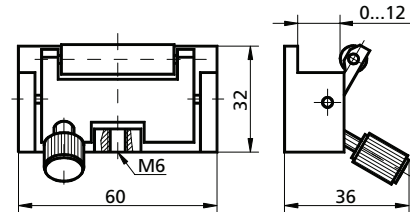

**830-0080 • 830-0090 LASER HOLDERS**



The 830-0080 and 830-0090 holders securely hold cylindrical objects like He-Ne alignment lasers at fixed position. The holders could be mounted directly to standard rods or on bases, translators and other surfaces with the help of screw.

Finish: black oxidized steel.

Code	A, mm	B, mm	C, mm	D, mm	E, mm	Weight, kg
830-0080	55	30	60	68	75	0.21
830-0090	35	16	40	48	58	0.15

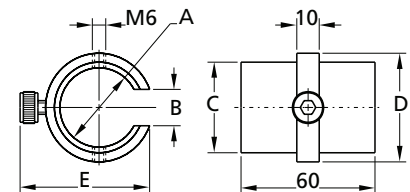

OPTICAL TABLES

BRACKETS & RAILS

BASE MOUNTS & ACCESSORIES

OPTICAL MOUNTS

OPTICAL POSITIONERS

BASE POSITIONERS

TRANSLATION & ROTATION STAGES

ADJUSTMENT SCREWS

MOTORIZED POSITIONERS

OPTO-MECHANICS SETS

**830-0100 • 830-0101**  
**830-0110 • 830-0111**
**RECTANGULAR OPTICS HOLDER**

**830-0110**
**830-0100**

Rectangular optics holders 830-0100 and 830-0110 provide easy and safe mounting of rectangular optics.

- Guiding pins ensure correct and reliable positioning of optical components
- M6 holes on two sides allow horizontal or vertical mounting

830-0101, 830-0111 have additional 1 mm raised edge for optics to stop against. Ideal for mounting rectangular windows and plano-concave cylindrical lenses.

You may put lens flat side on raised edges and lock with fixing bolt.

Finish: Black anodized aluminium.

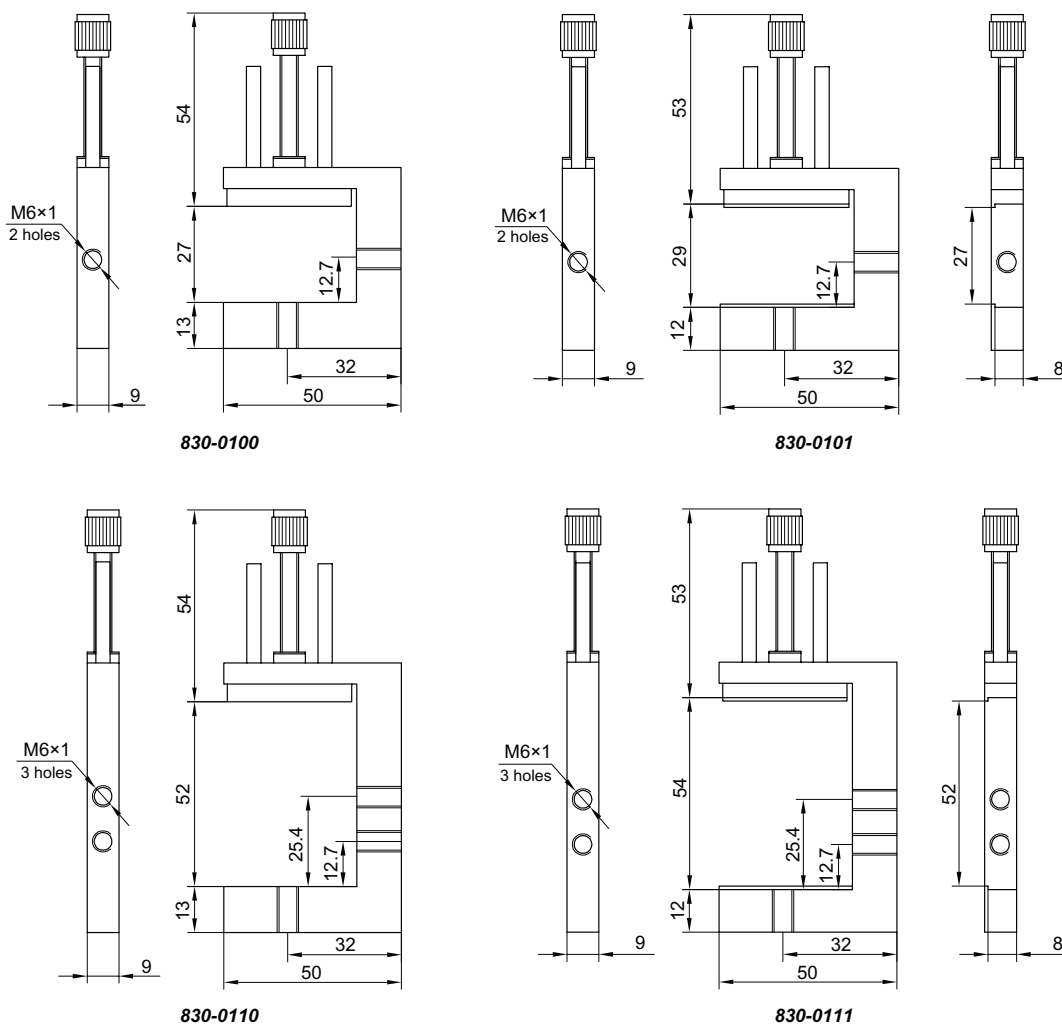
**830-0110 and 830-0100 with lenses**

Code	Suitable for optics height, mm	Weight, kg
<b>830-0100</b>	0–26	0.05
<b>830-0101</b>	2–28	0.05
<b>830-0110</b>	24.5–51	0.06
<b>830-0111</b>	26.5–53	0.06